



mitsubishi
ELECTRIC

Changes for the Better

HOME REFRIGERATORS

SERVICE MANUAL

2009

NO.SM-RE-0921

Models MR-260X-W-A
MR-260X-ST-A

CONTENTS

1. SPECIFICATIONS.....	1
2. OUTLINES AND DIMENSIONS.....	3
3. WIRING DIAGRAM.....	4
4. REFRIGERANT CIRCUIT.....	5
5. NAMES OF THE PARTS.....	6
6. TROUBLE SHOOTING.....	7
6.1 TROUBLE CRITERION OF MAIN PARTS.....	7
6.2 HOW TO CHECK P.C.BOARDS.....	9
6.3 TEST POINT DIAGRAM OF MAIN CONTROL BOARD.....	10
7. DISASSEMBLY INSTRUCTIONS.....	11
8. PARTS LIST.....	13

A.....Australia and New Zealand

1

SPECIFICATIONS

1.1 SPECIFICATIONS

MR-260X-A

Power supply		230/240V 50Hz	
Total capacity (Gross(AS))		L	260 (F:75 R:185)
Dimensions (HXWXD)		mm.	1592x555x642
Cabinet		Acrylic resin coated steel	
Food liner		ABS resin	
Insulation	Cabinet		Foamed cyclopentane
	Freezer door		Foamed cyclopentane
	Refrigerator door		Foamed cyclopentane
Cooling system	Freezer		Forced air convection
	Refrigerator		Forced air convection
Evaporator		Fin and tube type	
Condenser		Concealed type	
Defrost system		Automatic (Heater defrost)	
Drain		Automatic (drainage)	
Temperature control system		Automatic control	
Refrigerator room light		240V, 15W (E12)	
Accessories	Ice tray		1 pc.
	Ice box		1 pc.
	Freezer pocket		1 pc.
	Slide chilled case		1 pc.
	Crystal shelf (FS)		1 pc.
	Crystal shelf (FL)		1 pc.
	Glass shelf (R)		4 pcs.
	Free pocket		1 pc.
	Egg case		1 pc.
	Adjust pocket		2 pcs.
	Bottle pocket		2 pcs.
	Bottle stopper		1 pc.
	Vegetable case		1 pc.
	Drain pan		1 pc.
	Tray C		1 pc.
	Tray V		1 pc.
Weight	Unit	kg	53
	Shipping	kg	60

1.2 ELECTRICAL PARTS SPECIFICATION

MR-260X-A

Compressor	Model		DG51C89RAW5
			220/240V 50Hz
	Rated input	W	95/96 (220/240V 50Hz)
	Starting current	A	7.1/7.76 (220/240V 50Hz)
	Rated current	A	0.57/0.54 (220/240V 50Hz)
Winding resistance (A.T.20°C)			19 Ω(Main) / 17.1 Ω(Aux)
PTC Relay			PTH7M330MD2
Motor protector	Model		5TM166NHBYY-53
	Ambient temperature	°C	25
	Time	Sec	16 MAX
	Current	A	4.7
Capillary tube		mm.	∅ 1.8 X ∅ 0.55 X 2350
Dehydrant Molecular sieve		g	8
Refrigerant HFC. 134a		g	145
Defrosting control	Defrosting timer		Control board
	Defrost finish	°C	8.6 (Thermistor)
	Thermal fuse	°C	73
Deodorization			Filter
Heater	Defrost heater		304Ω (170V 95W)
Fan motor	Model		UDVH07MA2H
	Type		Single phase
	Number of poles		2p
	Input	W	Below 8.5/11 (220/240V 50Hz)
	Revolution	r.p.m	2390/2410±200 (220/240V 50Hz)
Running capacitor			4μF 400VAC

Temperature control	Model		Thermistor R(Refrigerator room)	
	Dial position		ON	OFF
	Warmer	°C	12.0	6.7
	Normal	°C	9.0	3.3
	Colder	°C	6.0	-0.2

2

OUTLINES AND DIMENSIONS

MR-260X-A

Unit : mm

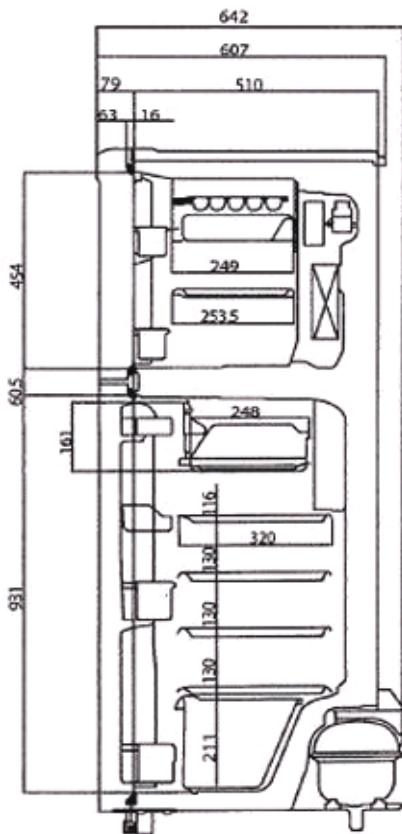
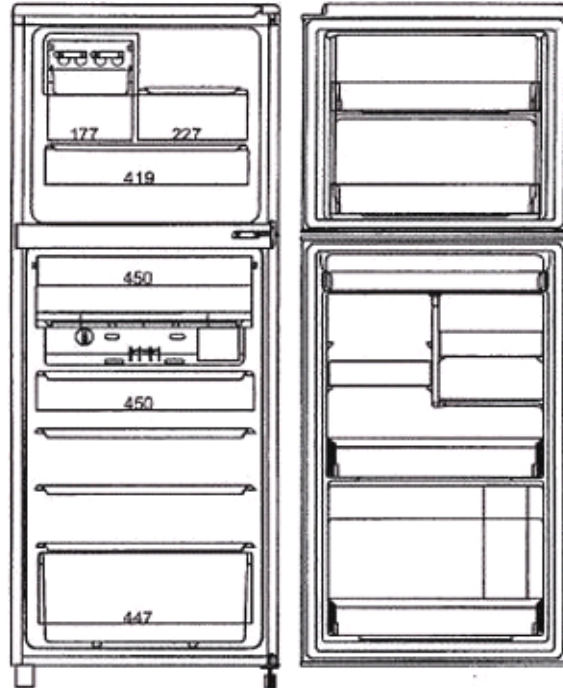
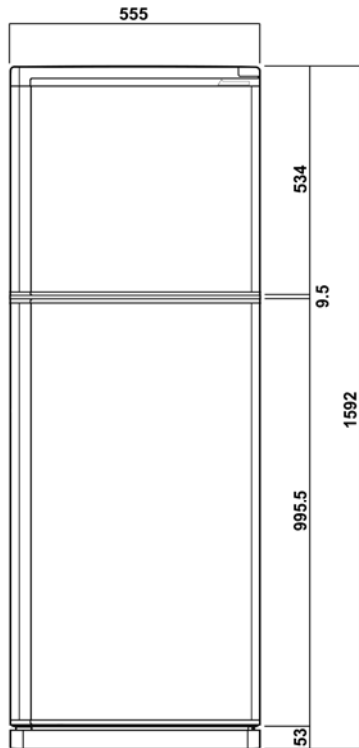

PLUG CORD LENGTH

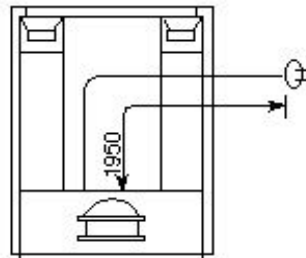

REQUIRED SPACE FOR INSTALLATION

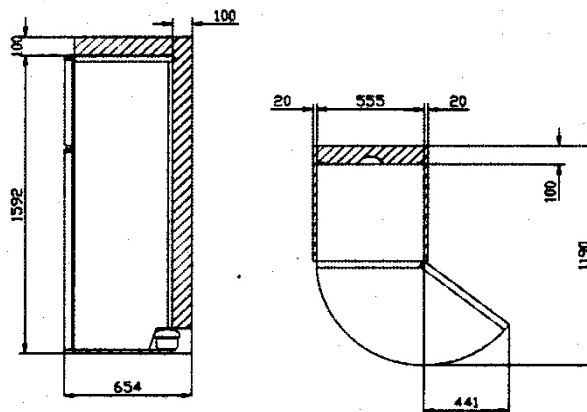

MR-260X-A

(SKELETON WIRING DIAGRAM)

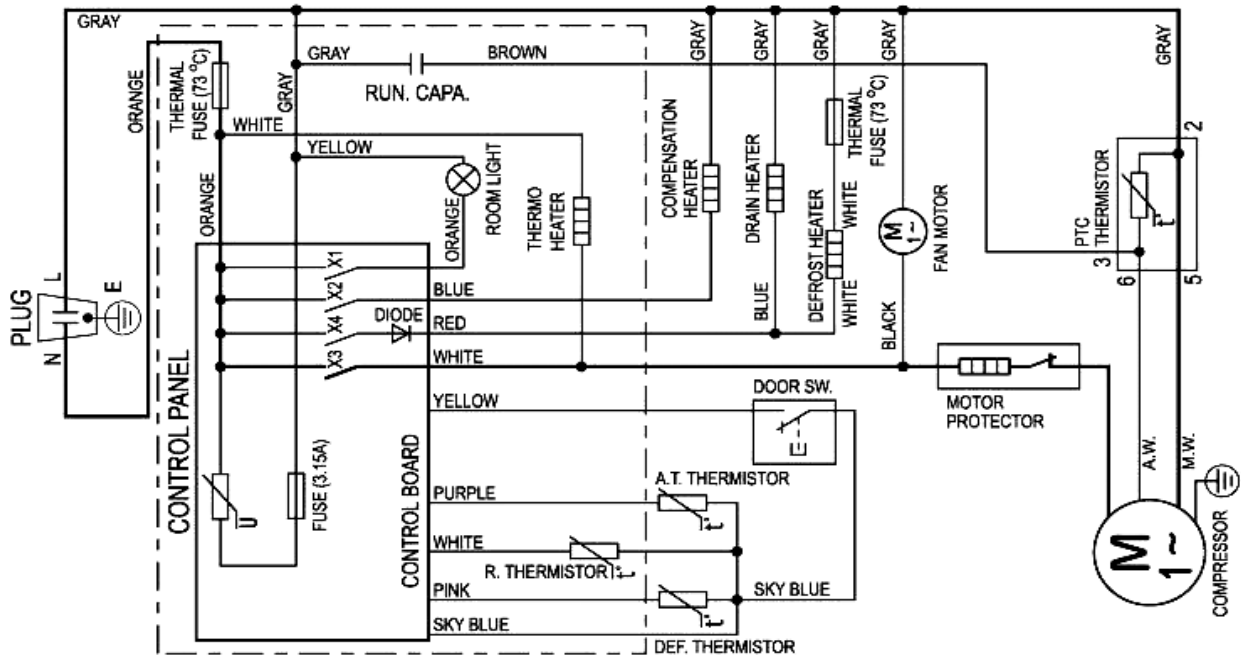

(ACTUAL WIRING DIAGRAM)

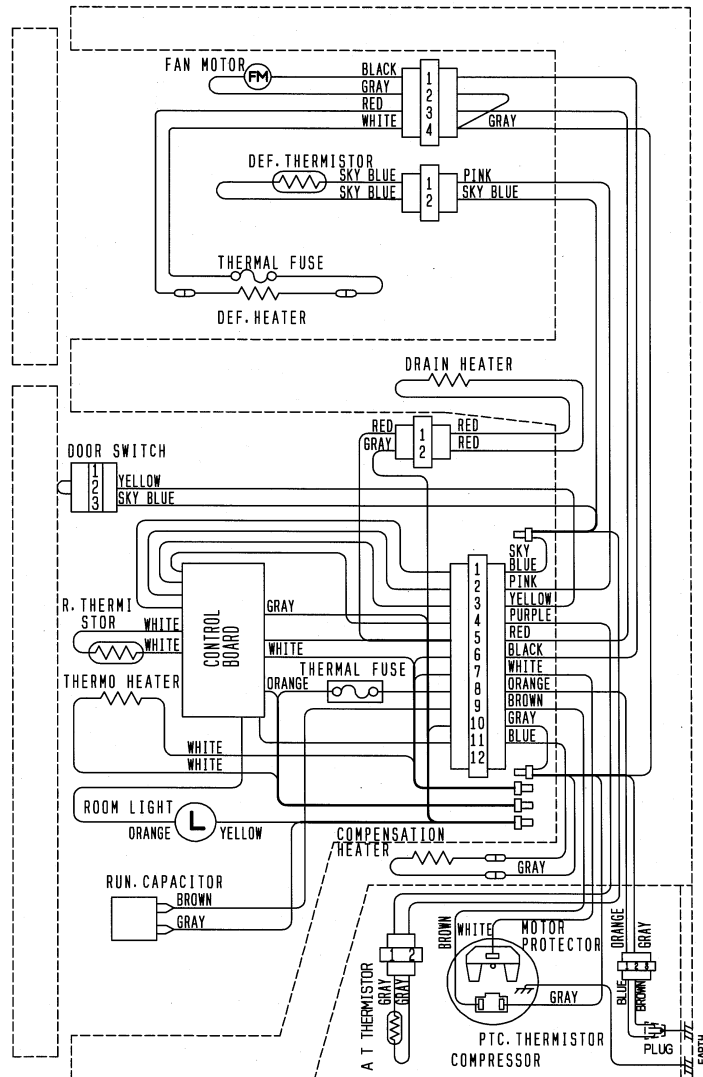

REFRIGERANT CIRCUIT

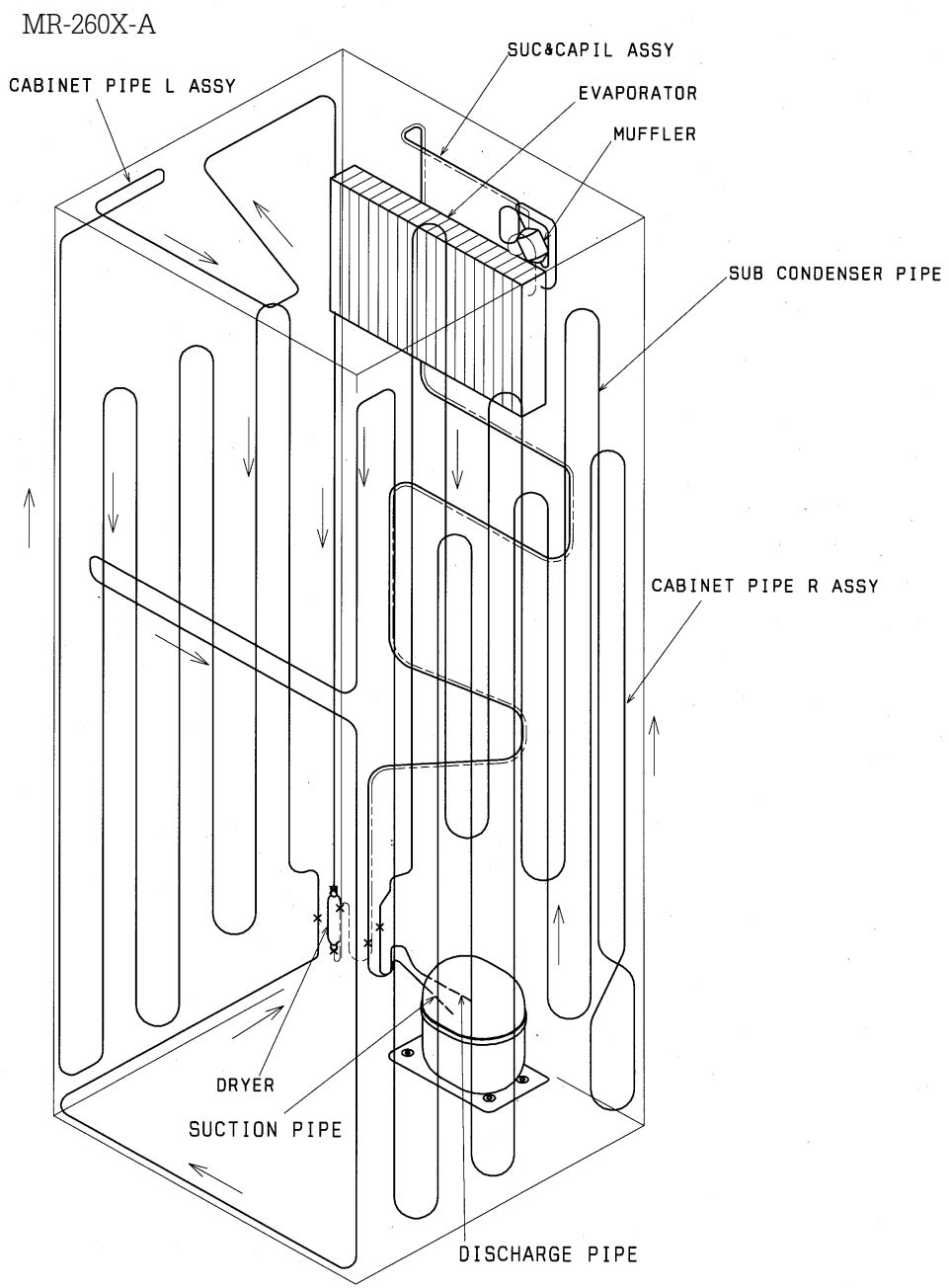

5

NAMES OF THE PARTS

MR-260X-A

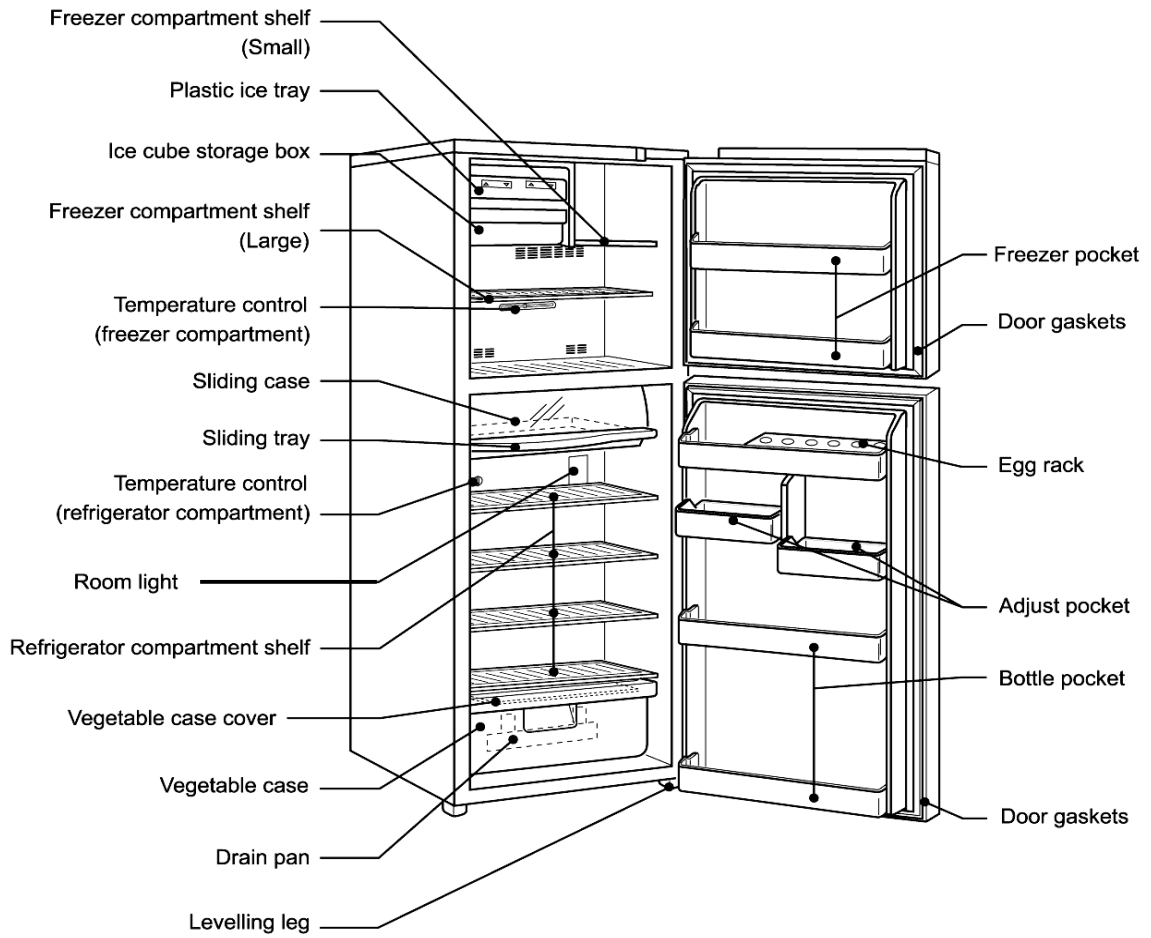

6

TROUBLE SHOOTING

6.1 TROUBLE CRITERION OF MAIN PARTS

MR-260X-A

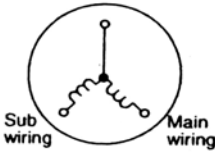
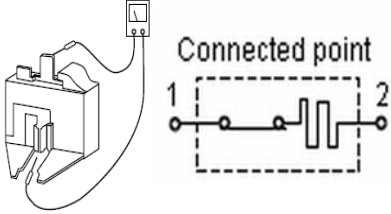
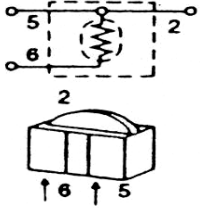
Components/ Part Name	Check Methode and Criterion	Parts Mounted Position																				
Compressor	<table border="1" data-bbox="429 557 1201 759"> <tr> <td colspan="2">Model</td> <td>DG51C89RAW5</td> </tr> <tr> <td>Rate input</td> <td>W</td> <td>95/96 (220/240V 50Hz)</td> </tr> <tr> <td>Starting current</td> <td>A</td> <td>7.1/7.76 (220/240V 50Hz)</td> </tr> <tr> <td>Rated current</td> <td>A</td> <td>0.57/0.54 (220/240V 50Hz)</td> </tr> </table>  <table border="1" data-bbox="715 770 1201 983"> <tr> <td></td> <td>Normal</td> <td>Abnormal (faulty)</td> </tr> <tr> <td>Main wiring</td> <td>19Ω (Approx.)</td> <td rowspan="2">Opened(∞ Ω) or Short (0Ω)</td> </tr> <tr> <td>Auxiliary wiring</td> <td>17.1Ω (Aprox.)</td> </tr> </table> <p>Measure the resistance with a tester. (Ambient temperature: Room temperature 15°C ~ 25°C)</p>	Model		DG51C89RAW5	Rate input	W	95/96 (220/240V 50Hz)	Starting current	A	7.1/7.76 (220/240V 50Hz)	Rated current	A	0.57/0.54 (220/240V 50Hz)		Normal	Abnormal (faulty)	Main wiring	19Ω (Approx.)	Opened(∞ Ω) or Short (0Ω)	Auxiliary wiring	17.1Ω (Aprox.)	Compressor in the machine chamber at the rear side of the frame
Model		DG51C89RAW5																				
Rate input	W	95/96 (220/240V 50Hz)																				
Starting current	A	7.1/7.76 (220/240V 50Hz)																				
Rated current	A	0.57/0.54 (220/240V 50Hz)																				
	Normal	Abnormal (faulty)																				
Main wiring	19Ω (Approx.)	Opened(∞ Ω) or Short (0Ω)																				
Auxiliary wiring	17.1Ω (Aprox.)																					
Motor protector	<table border="1" data-bbox="349 1176 1201 1348"> <tr> <td colspan="2">Model</td> <td>5TM166NHBYY-53</td> </tr> <tr> <td rowspan="2">Connected point</td> <td>Open</td> <td>120°C or more (4.7A or 5-16 second)</td> </tr> <tr> <td>Close</td> <td>69°C or less</td> </tr> </table> <p>(Ambient temperature: Room temperature 15°C ~ 25°C)</p>  <table border="1" data-bbox="794 1464 1201 1559"> <tr> <td>Normal</td> <td>Abnormal(Faulty)</td> </tr> <tr> <td>Less than 1Ω</td> <td>Opened (∞ Ω)</td> </tr> </table>	Model		5TM166NHBYY-53	Connected point	Open	120°C or more (4.7A or 5-16 second)	Close	69°C or less	Normal	Abnormal(Faulty)	Less than 1Ω	Opened (∞ Ω)	Compressor in the machine chamber at the rear side of the frame.								
Model		5TM166NHBYY-53																				
Connected point	Open	120°C or more (4.7A or 5-16 second)																				
	Close	69°C or less																				
Normal	Abnormal(Faulty)																					
Less than 1Ω	Opened (∞ Ω)																					
PTC Relay	 <table border="1" data-bbox="794 1697 1201 1744"> <tr> <td>Model</td> <td>PTH7M330MD2</td> </tr> </table> <p>Measure the resistance with a tester. (Ambient temperature: Room temperature 15°C ~ 25°C)</p> <table border="1" data-bbox="673 1886 1201 2024"> <tr> <td>Normal</td> <td>Abnormal(Faulty)</td> </tr> <tr> <td>33Ω (Approx.)</td> <td>Opened (∞ Ω) or Short (0Ω)</td> </tr> </table> <p>As PTC Relay thermistor has been heated while refrigerator is running, be sure to measure the resistance after the thermistor has got cool enough.</p>	Model	PTH7M330MD2	Normal	Abnormal(Faulty)	33Ω (Approx.)	Opened (∞ Ω) or Short (0Ω)	Compressor in the machine chamber at the rear side of the frame.														
Model	PTH7M330MD2																					
Normal	Abnormal(Faulty)																					
33Ω (Approx.)	Opened (∞ Ω) or Short (0Ω)																					

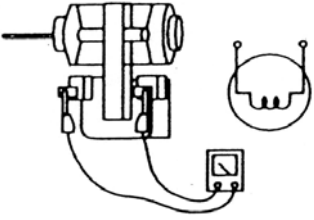
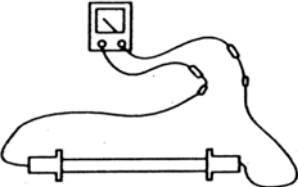
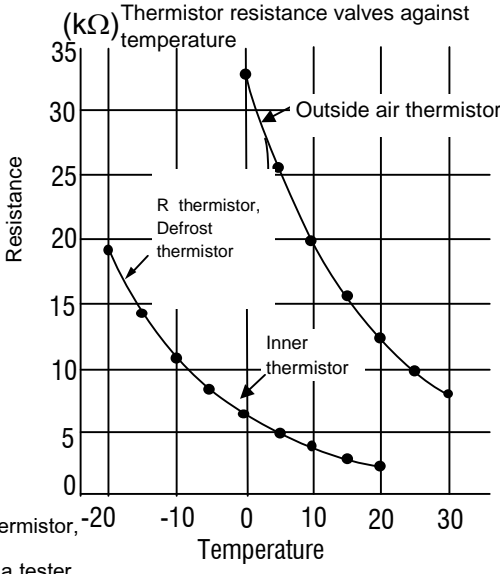
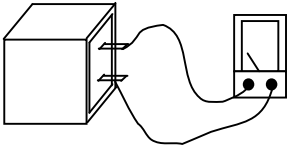
Components/ Part Name	Check Methode and Criterion	Parts Mounted Position										
Refrigerator fan motor	 <table border="1" data-bbox="758 353 1204 403"> <tr> <td>Model</td> <td>UDVH07MA2H</td> </tr> </table> <p>Measure the resistance with a tester. (Ambient temperature: Room temperature 25°C)</p> <table border="1" data-bbox="678 497 1204 638"> <tr> <td>Normal</td> <td>Abnormal(faulty)</td> </tr> <tr> <td>583±8%Ω</td> <td>Opened (∞ Ω) or Short (0Ω)</td> </tr> </table>	Model	UDVH07MA2H	Normal	Abnormal(faulty)	583±8%Ω	Opened (∞ Ω) or Short (0Ω)	Fan grill of the freezer compartment.				
Model	UDVH07MA2H											
Normal	Abnormal(faulty)											
583±8%Ω	Opened (∞ Ω) or Short (0Ω)											
Defrost heater	<table border="1" data-bbox="595 667 1204 817"> <tr> <td>Rated input</td> <td>W</td> <td>95</td> </tr> <tr> <td colspan="2">operation method</td> <td>Power ON after defrosting (14±1.5°C or more)</td> </tr> </table> <p>Measure the resistance with a tester. (Ambient temperature: Room temperature)</p>  <table border="1" data-bbox="678 952 1204 1093"> <tr> <td>Normal</td> <td>Abnormal(faulty)</td> </tr> <tr> <td>304Ω(Approx.)</td> <td>Opened (∞ Ω)</td> </tr> </table>	Rated input	W	95	operation method		Power ON after defrosting (14±1.5°C or more)	Normal	Abnormal(faulty)	304Ω(Approx.)	Opened (∞ Ω)	In drip tray under evaporator of the freezer compartment.
Rated input	W	95										
operation method		Power ON after defrosting (14±1.5°C or more)										
Normal	Abnormal(faulty)											
304Ω(Approx.)	Opened (∞ Ω)											
Thermistor	<ul style="list-style-type: none"> ● Resistance measured under the ambient temperature from -50: to +50: <ul style="list-style-type: none"> 1. 200" to 500k"Normal 2. Out of the above rangeAbnormal <p>Thermistor Check Procedure</p> <ul style="list-style-type: none"> ● Thermistor resistance will vary with the change of temperature. ● Take the temperature around the thermistor, and then measure resistance using a tester. <p>The relation of resistance and temperature is as shown on the above graph.</p> 	<p>Defrost thermistor at the muffler of evaporator in freezer compartment.</p> <p>R thermistor at control panel of the refrigerator compartment.</p> <p>Out air thermistor in the electric box at the rear side of the frame.</p>										
Run capacitor	 <table border="1" data-bbox="678 1825 1082 1877"> <tr> <td>Rated input</td> <td>400VAC</td> </tr> </table> <p>Measure the resistance with a tester.</p> <table border="1" data-bbox="678 1966 1082 2072"> <tr> <td>Normal</td> <td>Abnormal(faulty)</td> </tr> <tr> <td>Opened (∞ Ω)</td> <td>Short (0Ω)</td> </tr> </table>	Rated input	400VAC	Normal	Abnormal(faulty)	Opened (∞ Ω)	Short (0Ω)	In the control panel of the refrigerator compartment.				
Rated input	400VAC											
Normal	Abnormal(faulty)											
Opened (∞ Ω)	Short (0Ω)											

6.2 HOW TO CHECK P.C BOARDS

MR-260X-A

Unplug unit before checking

If the controller P.C. board box is opened with the refrigerator inside cooled, dew will form on the control board, causing trouble such as poor insulation.

The following cares must be taken when servicing.

1. Be sure to unplug the power cord before servicing.
2. Wipe away droplets on the control board box with dry cloth, and dry it up before setting a new controller P.C board.

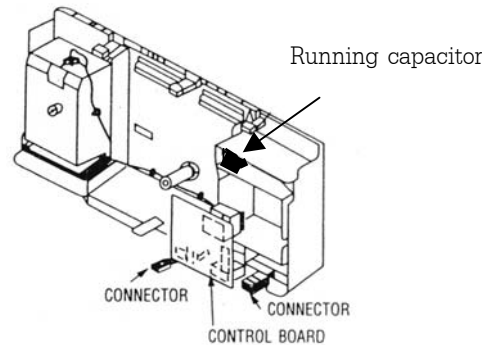

(2) How to check the controller P.C board and vicinity.

The control board box can be checked without opening the box. Measure the voltage and resistance using 2 connectors outside the box.

1. Check for 230/240VAC output during power on.

Make the pin No.10 of the 12 pins white connector as a common pin, and measure the voltage(AC) between the common pin and another pin.(Except pin no. 1,2,3,4)

Make sure that 230/240VAC is output.

Note: The room light always has 230/240VAC

2. Check for "thermistor" output during power on

Make the pin No.1 of the 12 pins white connector as a common pin, and measure the voltage(DC) between the common pin with pin no.2 and no.4

Make sure that 2~3 VDC is output

3. Check for weak current wiring power OFF

12 pins white connector

Remove the connector, and measure the resistance across

-No.1 pin and No.2 pin to confirm the continuity for DEF thermistor.

-No.1 pin and No.4 pin to confirm the continuity for A.T. thermistor.

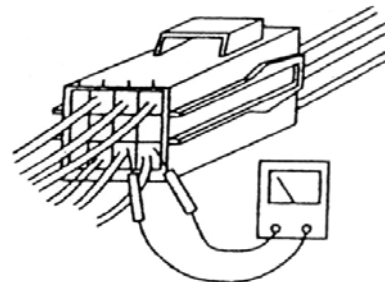

6.3 TEST POINT DIAGRAM OF MAIN CONTROL BOARD

MR-260X-A

Compulsory defrosting method

1. Open Door R adjust dial R at MID position
2. Press door switch while the door is opened then turn the dial as follow HI to LOW to MID ,the system will automatic defrost , if defrost thermistor can read more than 8.6 °C input current for 1 minute.

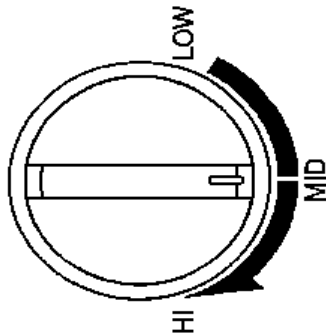

Note Method after plug in can make it defrost one time only, when want to check again have to plug out in again repeat follow plug method.

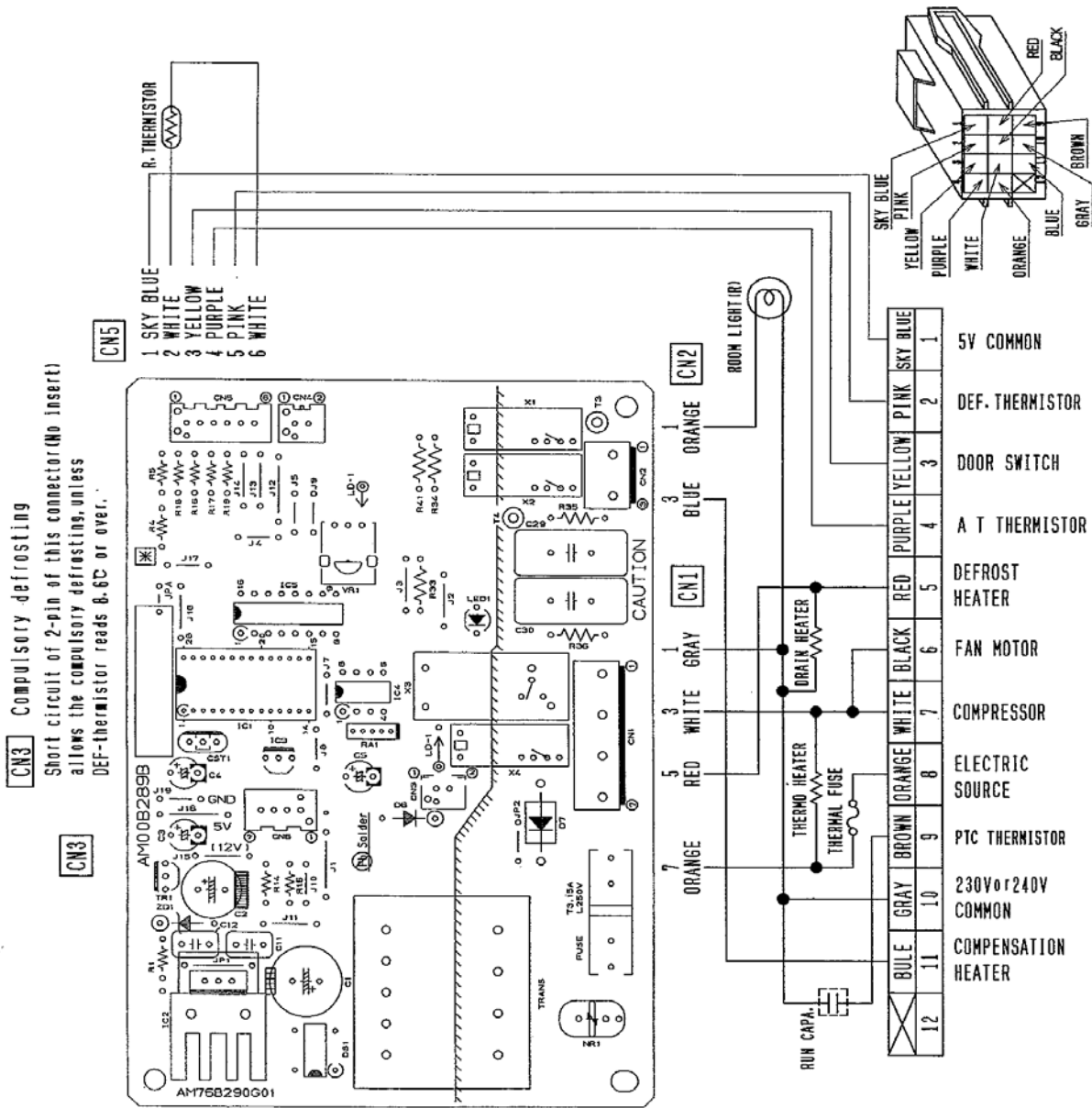

MR-260X-A

- Unplug the power cord before servicing.

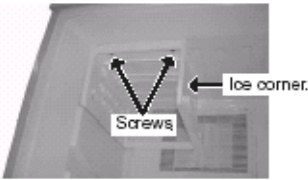
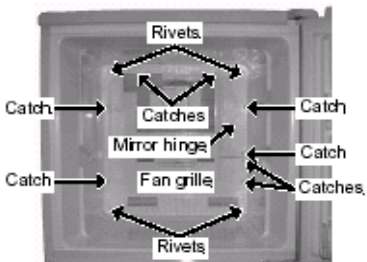
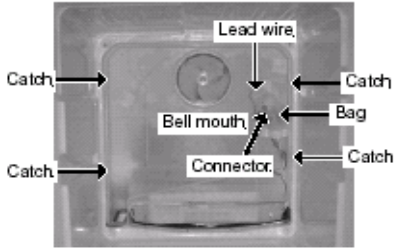
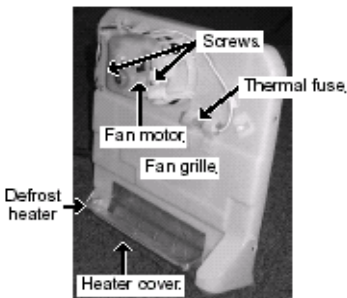
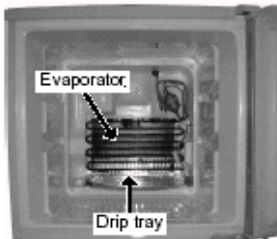
OPERATING PROCEDURE	PHOTOS
<p>1. Freezer room</p> <p>(1) Remove the parts inside the freezer compartment (freezer compartment shelf,Revolving ice tray,Ice cube storage box)</p> <p>Ice corner</p> <p>(2) Remove the 2 front screws and a left catch to take out the ice corner (See photo 1)</p> <p>Fan grille</p> <p>(3) Remove the 4 rivets and the 2 catches at mirror hinge section. Then remove the 6 catches to take out the fan grille. (See photo 2.)</p> <p>Bell mouth</p> <p>(4) Remove the 4 catches to take out the binder and the bag. Then remove the lead wire and the connector to take out the bell mouth. (See photo3.)</p> <p>Fan motor</p> <p>Remove the 2 screws of the motor mounting board and take out the fan motor.</p> <p>Thermal fuse</p> <p>Remove the connector and the plug to take out the thermal fuse. (See photo 3.)</p> <p>Defrost heater</p> <p>Make the catch at the left side of heater roof level and turn the defrost heater toward the rear side by 1/4 to pull it towards you. Then remove the 2 catches on the heater roof to detach the defrost heater from the bell mouth (See photo 4)</p> <p>CAUTION ON ASSEMBLY</p> <ol style="list-style-type: none"> 1. Insert the fan into the base of the fan motor's shaft . After attaching the motor, check if the fan rotates with your finger. 2. Attach defrost heater in place and slacken the lead wire in order to prevent water from entering the glass tube. 3. Attach the drip tray close to the inner box. 4. Attach the thermal fuse in place. 5. Attach the lead wires to the fixture. 	<p>Photo 1</p>  <p>Photo 2</p>  <p>Photo 3</p>  <p>Photo 4</p>  <p>Photo 5</p> 

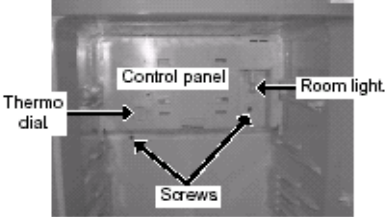
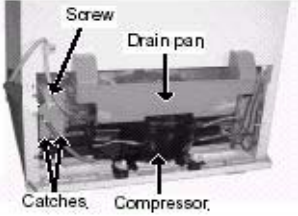

OPERATING PROCEDURE	PHOTO
<p>2. Refrigerator room</p> <p>(1) Remove the parts inside the refrigerator compartment (Slide chilled case , Refrigerator compartment shelf) Bend the slide chilled case lid the remove.</p> <p>Control panel and Duct R</p> <p>(2) Detach the room light cover.</p> <p>(3) Remove the 2 screws and the 2 connectors to pull the control panel and the duct R towards you.</p> <p>(4) Separate the control panel from the duct R.</p> <p>CAUTION ON ASSEMBLY</p> <ol style="list-style-type: none">1. Use new tapes and sealing materials for assembly.2. When putting some tapes across joints , tape them securely so that they will not leak the cool air.3. Attach a connector securely in order to prevent contacts failure	<p>photo 6</p>  <p>Photo 6 shows the interior of a refrigerator compartment. A control panel is visible, with a thermo dial on the left and a room light on the right. Two screws are indicated at the bottom of the control panel area.</p>
<p>3. Removing the compressor</p> <p>(1) Detach the drain pan.</p> <p>Compressor</p> <p>(2) Collect gas from the charge pipe on the high pressure side.</p> <p>(3) After collecting gas, cut the charge pipe on the low pressure side.</p> <p>(4) Detach the welded section of the discharge pipe and suction pipe</p> <p>(5) Replace the compressor and the dryer at a time. (The dryer should be the one packed with the compressor.)</p> <p>CAUTION ON ASSEMBLY</p> <p>After attaching the compressor , be sure to purge air and charge gas from charge pipe on low - pressure side.</p> <p>Arrange the piping so that the pipes will not hit each other and compressor cover , which causes loud noise . Then attach the compressor cover.</p> <p>When all the works are completed , be sure to check the cooling performance and the gas leak from the welded points.</p> <p>When attaching compressor cover , be careful so that carry handles will not be disconnected.</p>	<p>photo 7</p>  <p>Photo 7 shows the internal components of a refrigerator. A screw is visible at the top left, a drain pan is in the center, and catches and a compressor are at the bottom.</p>

8

PARTS LIST

DOOR , BODY PARTS

MR-260X-A

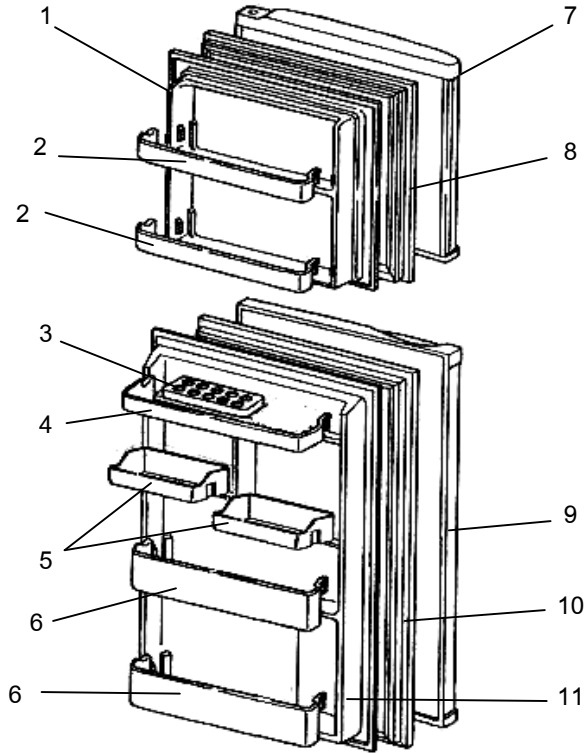

DOOR , BODY PARTS

NO.	PART NO.	RoHS	PART NAME	SPEC	Q'TY/UNIT		PRICE/PIECE(US\$-FOB)	EXPIRY
					MR-260X			
					A			
					W	ST		
1	KIEH68101	<G>	DOOR LINER (F)		1	1		2012
2	KIEGT5131	<G>	FREEZER POCKET		2	2		2012
3	KIEL01116	<G>	EGG CASE		1	1		2012
4	KIEL07118	<G>	FREE POCKET		1	1		2012
5	KIEJ44159	<G>	ADJUST POCKET		2	2		2012
6	KIEGB1124	<G>	BOTTLE POCKET		2	2		2012
7	KIEN97001	<G>	DOOR F		1			2012
	KIEN78001	<G>				1		2012
8	KIEG67111	<G>	MAGNET GASKET ASSY (F)		1	1		2014
9	KIEM92000	<G>	DOOR R		1			2012
	KIEM61000	<G>				1		2012
10	KIEG67110	<G>	MAGNET GASKET ASSY (R)		1	1		2014
11	KIEH68100	<G>	DOOR LINER (R)		1	1		2012

RECOMMEND PART NO. 7, 8, 9, 10

ABBREVIATION

F	FREEZER ROOM
R	REFRIGERATOR ROOM

ENCIRCLED PART NUMBER ARE NOT SHOWN IN THE FIGURES.

Remark

- Country code : A= Australia and New Zealand
- Colour code : W = White, ST = Stainless

ACCESSORY PARTS

MR-260X-A

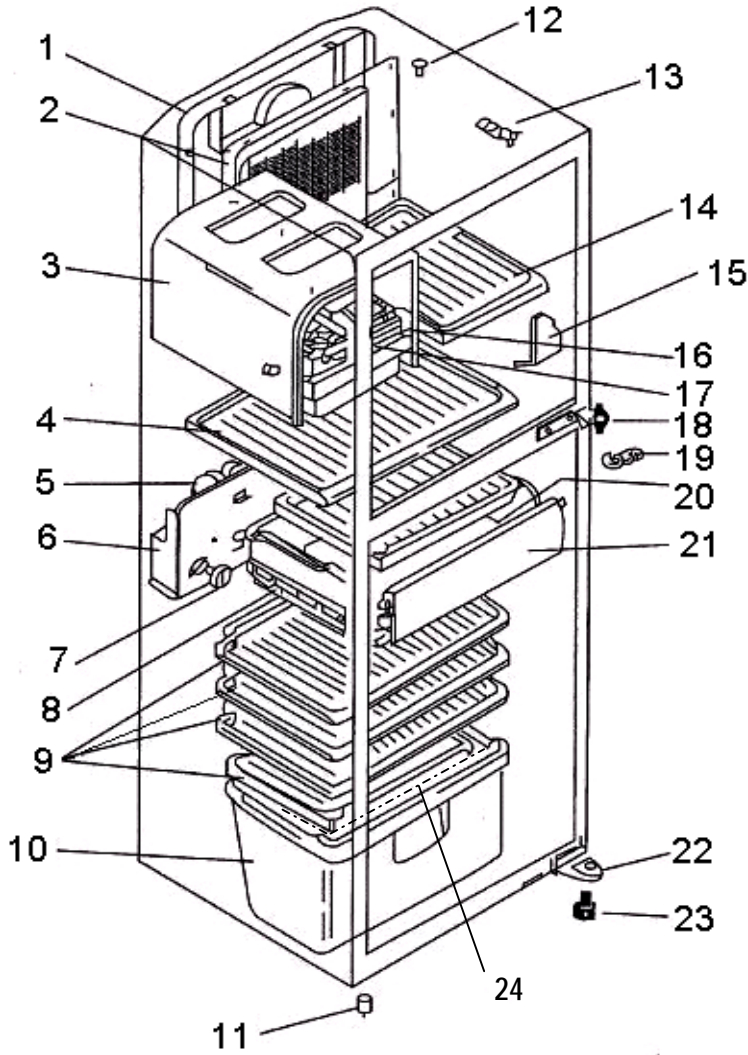

ACCESSORY PARTS

NO.	PART NO.	RoHS	PART NAME	SPEC	Q'TY/UNIT		PRICE/PIECE (US\$-FOB)	EXPIRY
					MR-260X			
					A			
					W	ST		
1	KIEM92662	<G>	BELL MOUTH		1	1		2012
2	KIEM92663	<G>	FAN GRILLE		1	1		2012
3	KIEH61450	<G>	ICE CORNER		1	1		2012
4	KIEG59431	<G>	CRYSTAL SHELF (FL)		1	1		2012
5	KIEMQ2665	<G>	DUCT R ASSY		1	1		2012
6	KIEL98850	<G>	CONTROL PANEL		1	1		2012
7	KIEL46305	<G>	THERMO DIAL (R)		1	1		2014
8	KIEG63411	<G>	SLIDE CHILLED CASE		1	1		2012
9	KIEM58430	<G>	GLASS SHELF R ASS'Y		4	4		2012
10	KIEM42405	<G>	VEGETABLE CASE		1	1		2012
11	KIE401461	<G>	LEG		1	1		2012
12	KIEA74654	<G>	SPECIAL RIVET		4	4		2012
13	KIEM21701	<G>	HINGE UP ASSY		1	1		2012
14	KIEG63431	<G>	CRYSTAL SHELF (FS)		1	1		2012
15	KIEA74470	<G>	LAMP COVER		1	1		2012
16	KIEL55440	<G>	ICE TRAY		1	1		2012
17	KIEG63487	<G>	ICE BOX		1	1		2012
18	KIEG59703	<G>	HINGE MID ASSY		1	1		2012
19	KIEA74745	<G>	CATCHER		1	1		2014
20	KIEG63416	<G>	TRAY C		1	1		2012
21	KIEL55418	<G>	CHILLED CASE DOOR		1	1		2012
22	KIEG59702	<G>	HINGE LR ASSY		1	1		2012
23	KIEH57460	<G>	ADJUST FOOT		1	1		2012
24	KIEM92468	<G>	TRAY V		1	1		2012
(25)	KIEM42200	<G>	TOP TABLE		1			2012
	KIEM61200	<G>					1	
(26)	KIEM92305	<G>	SHUTTER F		1	1		2014

RECOMMEND PART NO. 2,3,5,9,10,13,14,15,16,19,20

ABBREVIATION

F	FREEZER ROOM
R	REFRIGERATOR ROOM

ENCIRCLED PART NUMBER ARE NOT SHOWN IN THE FIGURES.

ELECTRICAL PARTS AND UNIT PARTS

MR-260X-A

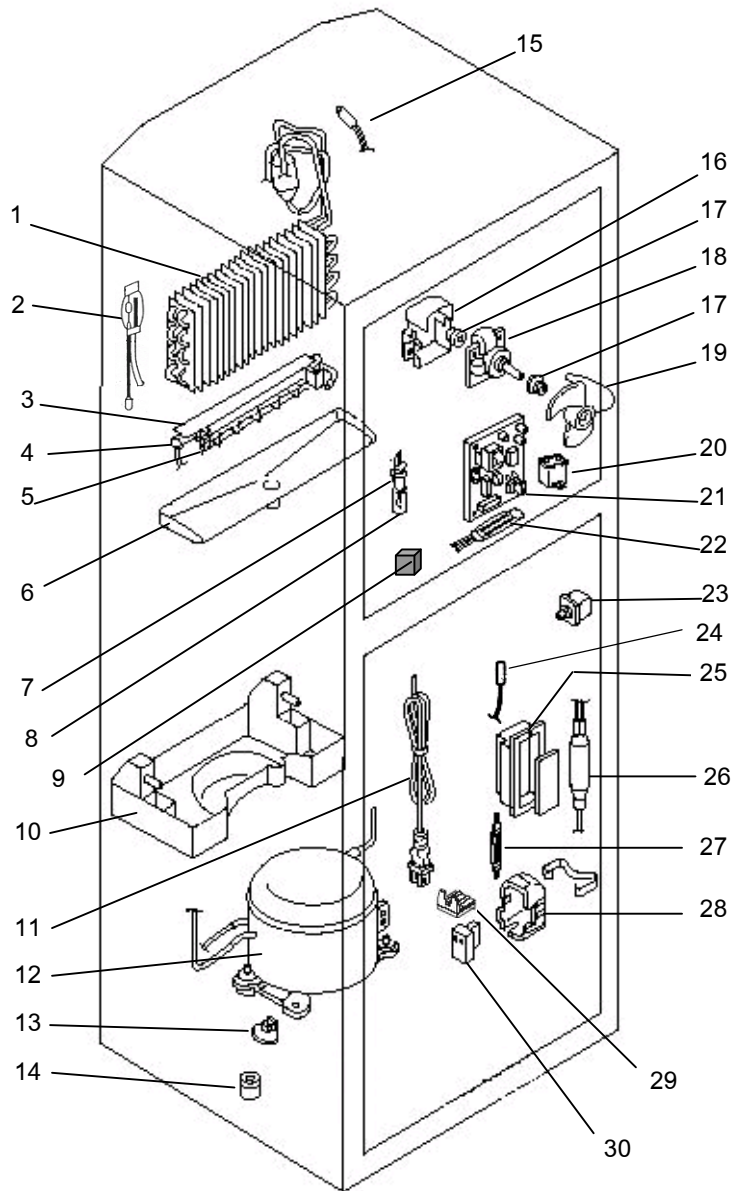

ELECTRICAL PARTS AND UNIT PARTS

NO.	PART NO.	RoHS	PART NAME	SPEC	Q'TY/UNIT		PRICE/PIECE(US\$-FOB)	EXPIRY
					MR-260X			
					A			
					W	ST		
1	KIEMQ2995	<G>	EVAPORATOR		1	1		2014
2	KIEJ79336	<G>	THERMAL FUSE (DEF)		1	1		2014
3	KIEG13537	<G>	HEATER ROOF		1	1		2014
4	KIEJ79392	<G>	DEFROST HEATER ASSY		1	1		2014
5	KIEH57397	<G>	HEATER COVER		1	1		2014
6	KIEG59538	<G>	DRIP TRAY		1	1		2014
7	KIEJ79386	<G>	LAMP SOCKET		1	1		2014
8	KIE402360	<G>	LAMP		1	1		2014
9	KIEH61399	<G>	FILTER		1	1		2012
10	KIEG59435	<G>	DRAIN PAN		1	1		2014
11	KIEJ79354	<G>	PLUG CORD ASSY		1	1		2014
12	KIEGT5277	<G>	COMPRESSOR		1	1		2014
13	KIEG13735	<G>	LOCK WASHER		4	4		2012
14	KIEA01797	<G>	RUBBER MOUNT		4	4		2012
15	KIEG59312	<G>	THERMISTOR (DEF)		1	1		2014
16	KIEA74323	<G>	MOTOR ATTACH		1	1		2014
17	KIE401329	<G>	FAN MOTOR BUSH		2	2		2014
18	KIEB66320	<G>	FAN MOTOR		1	1		2014
19	KIEB66321	<G>	FAN		1	1		2014
20	KIECC9346	<G>	RUNNING CAPACITOR		1	1		2014
21	KIEM92339	<G>	REFCON ASSY		1	1		2014
22	KIEH61336	<G>	THERMAL FUSE		1	1		2014
23	KIEH79363	<G>	LAMP SWITCH		1	1		2014
24	KIEHJ3311	<G>	THERMITOR (A.T.)		1	1		2014
25	KIEHC2807	<G>	CONNECTOR BOX ASSY		1	1		2012
26	KIEA01980	<G>	DRYER		1	1		2014
27	KIECD4313	<G>	THERMISTOR (R)		1	1		2014
28	KIEG05341	<G>	PROTECTOR COVER		1	1		2012
29	KIEG59340	<G>	MOTOR PROTECTOR		1	1		2014
30	KIEE76330	<G>	PTC RELAY		1	1		2014

RECOMMEND PART NO. 2,4,6,8,9,10,12,15,22,25,28

ABBREVIATION

DEF	DEFROST
R	REFRIGERATOR ROOM

PACKING PARTS

MR-260X-A

**3
TOP CUSHION(REAR)**

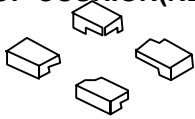

**2
TOP CUSHION(FRONT)**

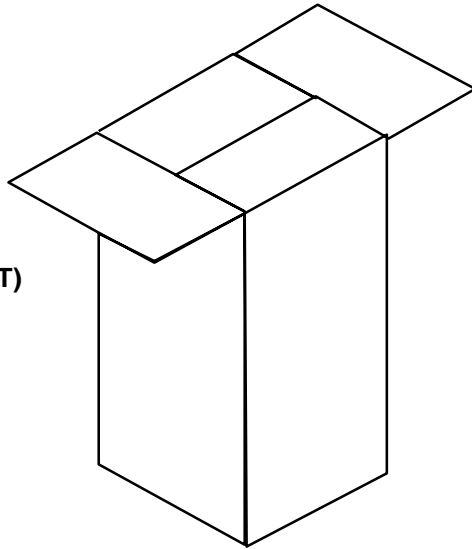

**1
C.F.B BOX ASSY**

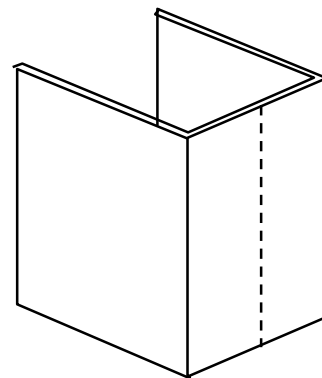

**5
SIDE CUSHION ASSY**

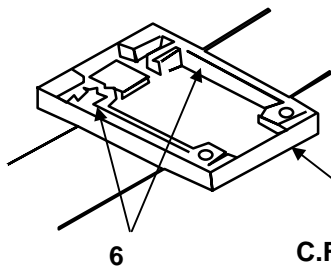

**6
BOTTOM CUSHION**

**7
C.F.B PALLET**

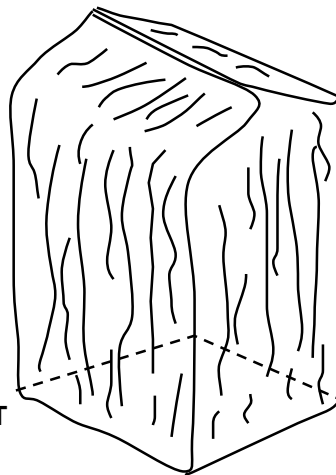

**4
PACKING COVER**

PACKING PARTS

NO.	PART NO.	RoHS	PART NAME	SPEC	Q'TY/UNIT		PRICE/PIECE(US\$-FOB)	EXPIRY
					MR-260X			
					A			
					W	ST		
1	KIEN97970	<G>	C.F.B BOX ASSY		1			2010
1	KIEN98970	<G>				1		2010
2	KIEM42979	<G>	TOP CUSHION (FRONT)		1	1		2010
3	KIEM46979	<G>	TOP CUSHION (REAR)		1	1		2010
4	KIEG67973	<G>	PACKING COVER		1	1		2010
5	KIEEC3971	<G>	SIDE CUSHION ASSY		1	1		2010
6	KIEM42978	<G>	BOTTOM CUSHION		1	1		2010
7	KIEG63974	<G>	C.F.B PALLET		1	1		2010



MITSUBISHI ELECTRIC CORPORATION

HEAD OFFICE : MITSUBISHI DENKI BLDG., MARUNOUCHI, TOKYO 100. TELEX : J24532 CABLE MELCO TOKYO

Distributed by

MITSUBISHI ELECTRIC AUSTRALIA PTY LTD.

(Incorporated in New South Wales) ABN 58 001 215 792

New South Wales :
348 Victoria Road,
Rydalme NSW 2116
Ph : (02) 9684 7777
Fax : (02) 9898 1043

Queensland:
Unit 12, 469
Nudgee Road,
Hendra QLD , 4011
Ph : (07) 3263 2000
Fax : (07) 3630 1888

South Australia /
Northern territory :
77 Port Road
Hindmarsh SA 5007
Ph: (08) 8340 2000
Fax : (08) 8340 0555

Western Australia :
329 Collier Road,
Bassendean WA 6054
Ph : (08) 9377 3400
Fax : (08) 9377 3499

Victoria / Tasmania :
Building 28, Omnico bus. Park
270 Ferntree Gully Road,
Notting Hill 3168
Ph : (03) 9535 7800
Fax : (03) 9535 7801

Far North
Queensland:
Capricorn Air,
13 Mackley St,
Garbutt 4814
Ph: (07) 4775 5222
Fax : (07) 4775 5303

Distributed by

BLACK DIAMOND TECHNOLOGIES LIMITED (BDT)

Wellington Office (Head Office)
1 Parliament Street
PO Box 30-772
Lower Hutt
Ph : (04) 560 9100
Fax : (04) 560 9133

Auckland Office
Unit1, 4 Walls Road
Penrose
Auckland PO Box 12-726
Ph: (09) 526 9340
Fax : (09) 526 9369

Christchurch Office
Suite 2, Level 1
37 Manderville Street
Christchurch PO Box 1604
Ph : (03) 341 7052
Fax : (03) 341 7054