

HEAT RECOVERY VENTILATORS FOR RESIDENTIAL USE



MODEL

VL-100U-E

Energy Saving

Reduced heat loss contributes to lower air conditioning costs.

Quiet Operation

Super sound insulation and quiet operation.

Fresh Air

Simultaneous air supply/exhaust function ensures that air stays fresh with efficient ventilation.

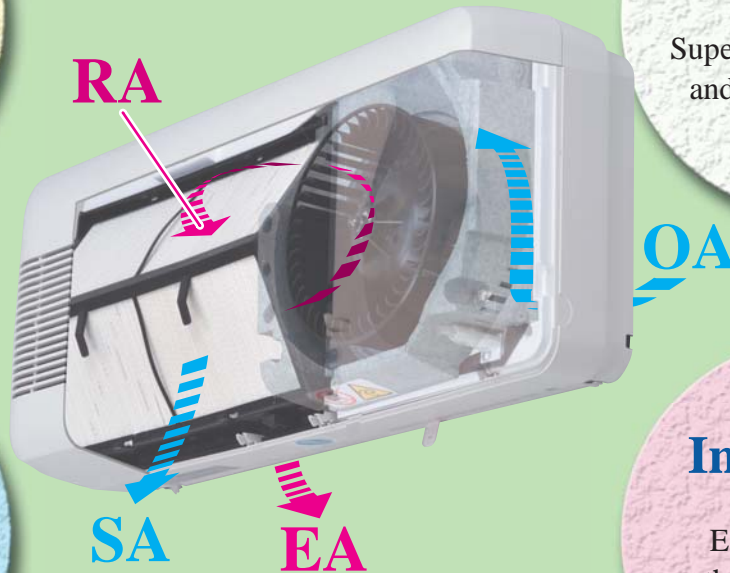

Simple Installation

Easy Installation through boring of 2 installation holes.

Total-Heat-Exchange Concept

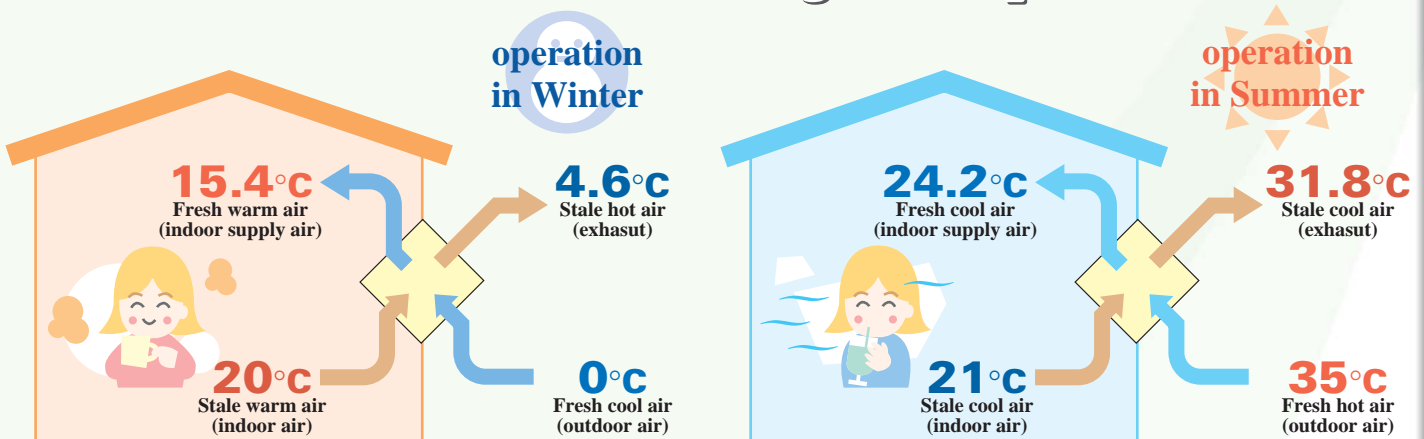

•Heat-exchange calculating equation

$$\text{Indoor supply-air temperature}(\text{°C}) = \left\{ \text{Indoor temperature}(\text{°C}) - \text{Outdoor temperature}(\text{°C}) \right\} \times \text{Temp exchange efficiency}(\%) + \text{Outdoor temperature}(\text{°C})$$

Calculation example : 15.4°C = (20°C - 0°C) x 77% + 0°C (Low notch)

•Heat-exchange calculating equation

$$\text{Indoor supply-air temperature}(\text{°C}) = \text{Outdoor temperature}(\text{°C}) + \left\{ \text{Indoor temperature}(\text{°C}) - \text{Outdoor temperature}(\text{°C}) \right\} \times \text{Temp exchange efficiency}(\%)$$

Calculation example : 35°C = (35°C - 21°C) x 77% (Low notch)

Specifications

VL-100U-E (White)



- Simple installation through boring of 2 installation holes.
- Low-noise (Less than 30dB at low notch).
- 1-motor 2-fan system.
- Air-volume: low/high 2-notch.
- Air-supply/exhaust pipes and plastic weather cover are supplied as accessories.
- Equipped with an outdoor-air shutter.
- Pull-string switch

| Supply Voltage (V) | Power line frequency (Hz) | Notch | Air volume (m ³ /h) | Power Consumption (W) | Temp.exchange efficiency (%) | Noise (dB) | Weight (kg) |
|--------------------|---------------------------|-------|--------------------------------|-----------------------|------------------------------|------------|-------------|
| 220-240 | 50 | HI | 105 | 26 | 70 | 39 | 6.5 |
| | | LO | 65 | 23 | 77 | 29.5 | |
| 220 | 60 | HI | 90 | 26 | 73 | 37 | |
| | | LO | 50 | 21 | 80 | 26 | |

Dimensions

VL-100U-E

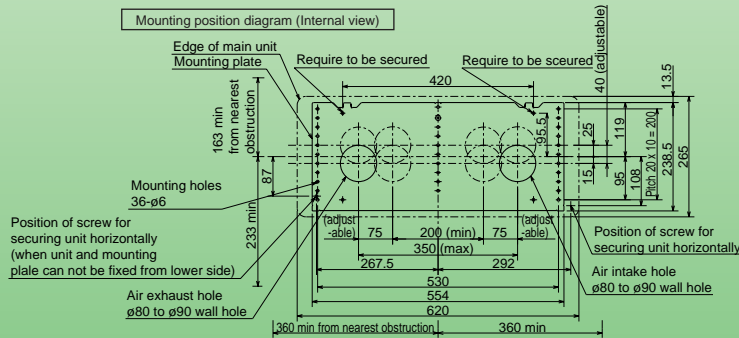
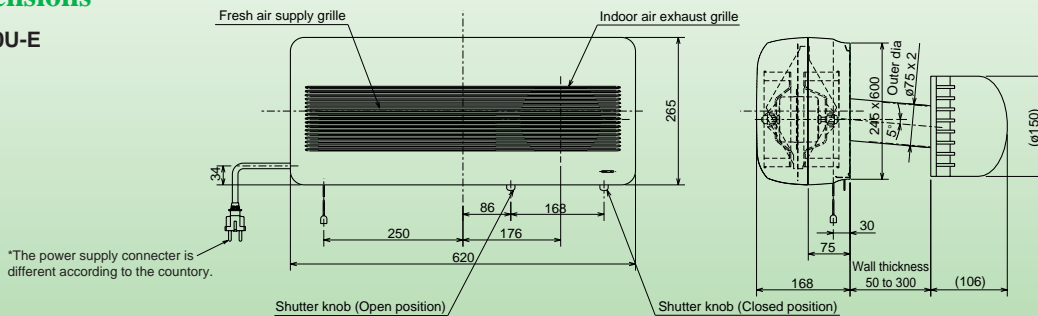

(unit: mm)

Wiring Diagram

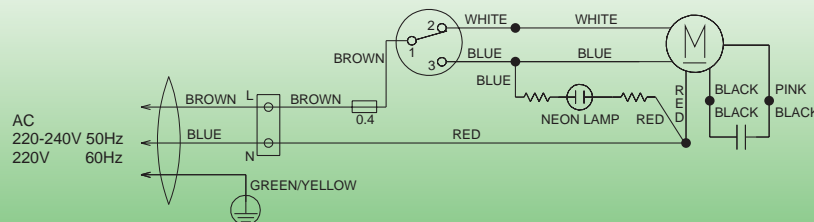

Optional parts

Extension Pipe P-100P

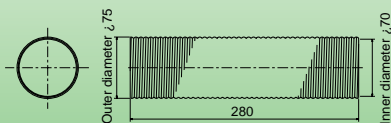

(unit: mm)

Extension Pipe Coupling P-100PJ

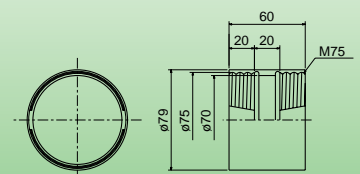

(unit: mm)

- Total length when connected to the pipe extension coupling is 300mm.

- Screw-in method